

ALKIMIA

CHARTER BROCHURE





BUILDER Sunreef Yachts



BUILT 2015/2025

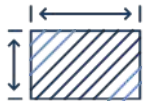

LENGTH 22.41 meters - 73'5"
BEAM 10.40 meters - 34'1"



GUEST CAPACITY 10 guests sleeping
CABINS 4 cabins



CREW Captain + 2



BASE PORT Summer -
South of France,
Corsica and Sardinia



CRUISING SPEED 8 knots



CRUISING AREA Summer -
South of France,
Corsica and Sardinia



WEEKLY RATE Price Upon Request



CONTRACTS MYBA Charter Contract

OVERVIEW

Alkimia, an easy rhythm shaped by the sea

Alkimia was launched in 2015 and refitted in 2025, offering a refreshed and welcoming setting for life at sea. Designed with comfort and ease in mind, she brings together generous living spaces and a calm, open atmosphere that invites you to slow down and settle into the rhythm of the water.

Her expansive 45 sqm cockpit flows naturally into a bright, open saloon, creating a seamless connection between indoor and outdoor living. Panoramic windows fill the interiors with natural light throughout the day, while soft seating areas and thoughtfully arranged spaces provide the perfect setting to relax, gather, or simply take in the surroundings.

Life on board Alkimia unfolds effortlessly, from quiet mornings at anchor to long, unhurried evenings spent outdoors. Each space is designed to feel open, comfortable, and easy to enjoy, offering a setting that encourages time well spent at sea.





























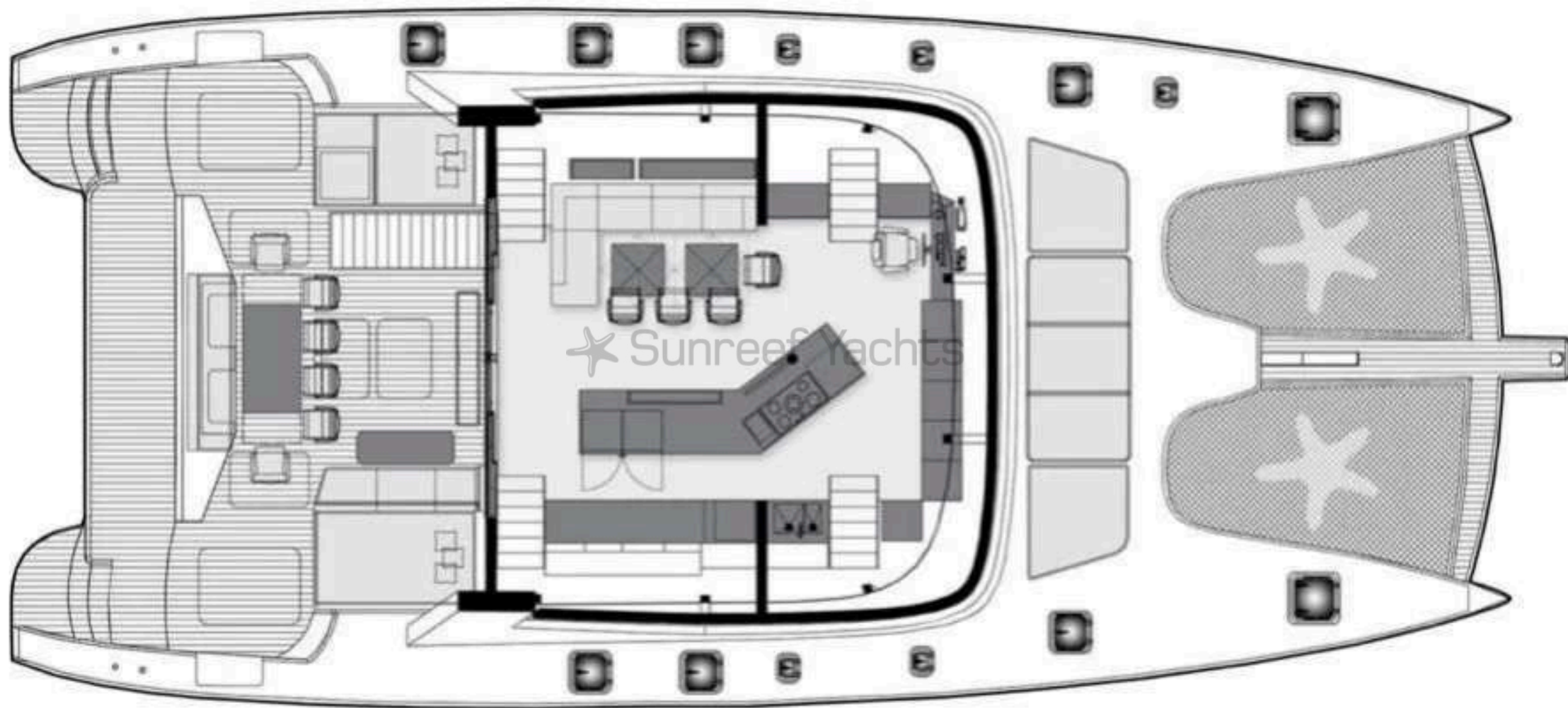

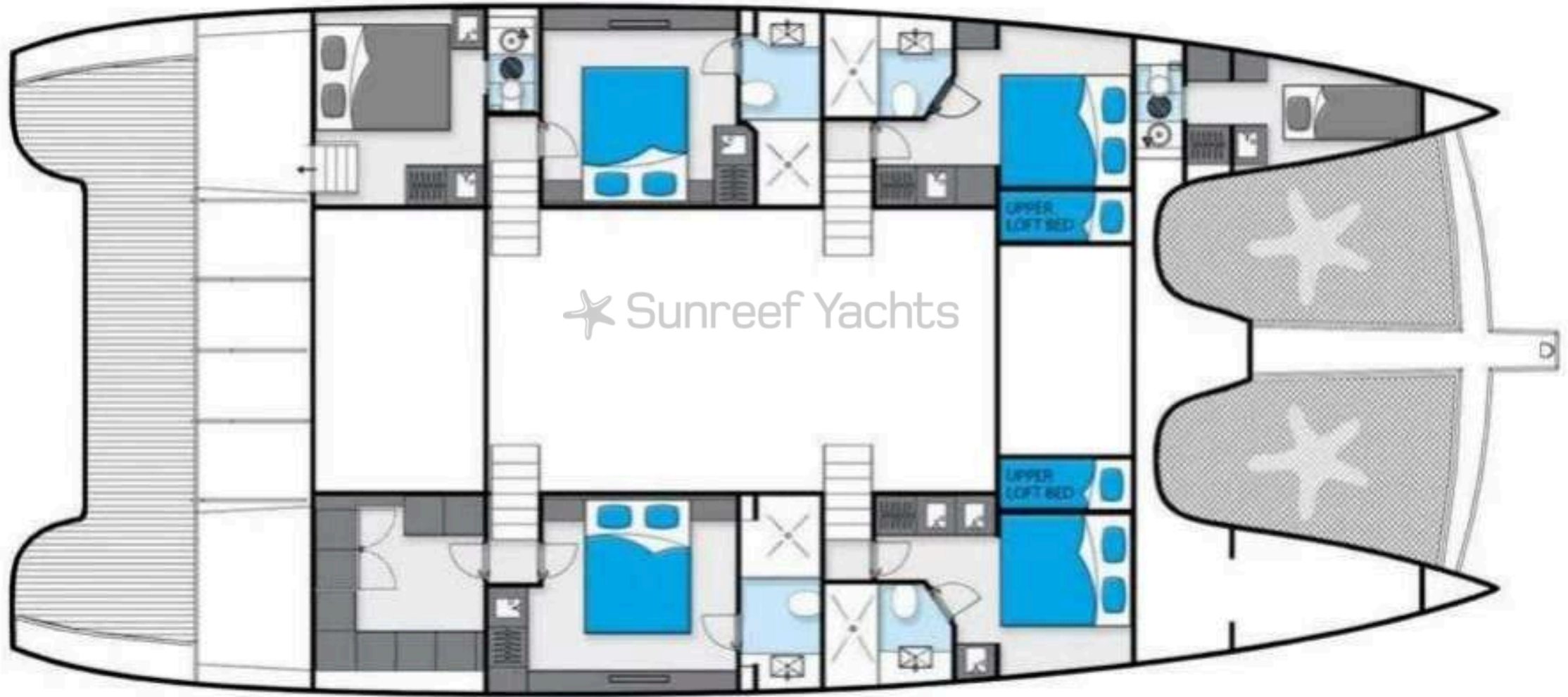

As yacht charter brokers, we provide the information in this brochure for general guidance. While we aim for accuracy, details, availability, and pricing are subject to change based on negotiations with yacht owners and other considerations. We make no warranties, express or implied, regarding the completeness, reliability, or suitability of the information. Yacht specifications and features may vary, and images are for illustrative purposes only.

This brochure does not constitute a contractual offer, and terms must be confirmed in writing. Charter terms, availability, and conditions may differ. Prospective charterers are advised to conduct their own due diligence and seek professional advice before making decisions based on this information.

